

Maldives Land and Survey Authority,

MINISTRY OF HOUSING AND INFRASTRUCTURE

Ameenee Magu, Maafannu, Male', 20392, Maldives.

Office (PABX): +(960) 3004300, Fax: +(960) 3004254

Email: survey@mhe.gov.mv

Web: www.surveyofmaldives.gov.mv, www.mhe.gov.mv



CONTROLPOINT DETAILS		Station Number	PSM 0115
Coordinate Information			
Geodetic		Grid	
WGS 84		UTM Zone 43	
Lat:	3° 29' 02.61818" N	E:	264239.1682
Long:	72° 52' 40.31400" E	N:	385363.5652
Ellp Height:		Orth Height:	+1.744
Island Name:	Adh.Dhidhdhoo	Date:	07 January 2015

Monument description & method of survey:

- Stainless steel plate fixed to concrete by two bolts
- Horizontal coordinates fixed by GNSS Static survey.
- Elevation reduced relative to Local MSL by double level run
- A concrete block (1x1 ft and 3.2ft in height) with 1.5m stainless steal rod (12mm) was fixed as a PSM

General site condition & access:

- Easily accessible area with wide angle of sky visibility
- Located in Adh.dhidhdhoo island council office boundary

Owner: Adh.Dhidhdhoo Island Council



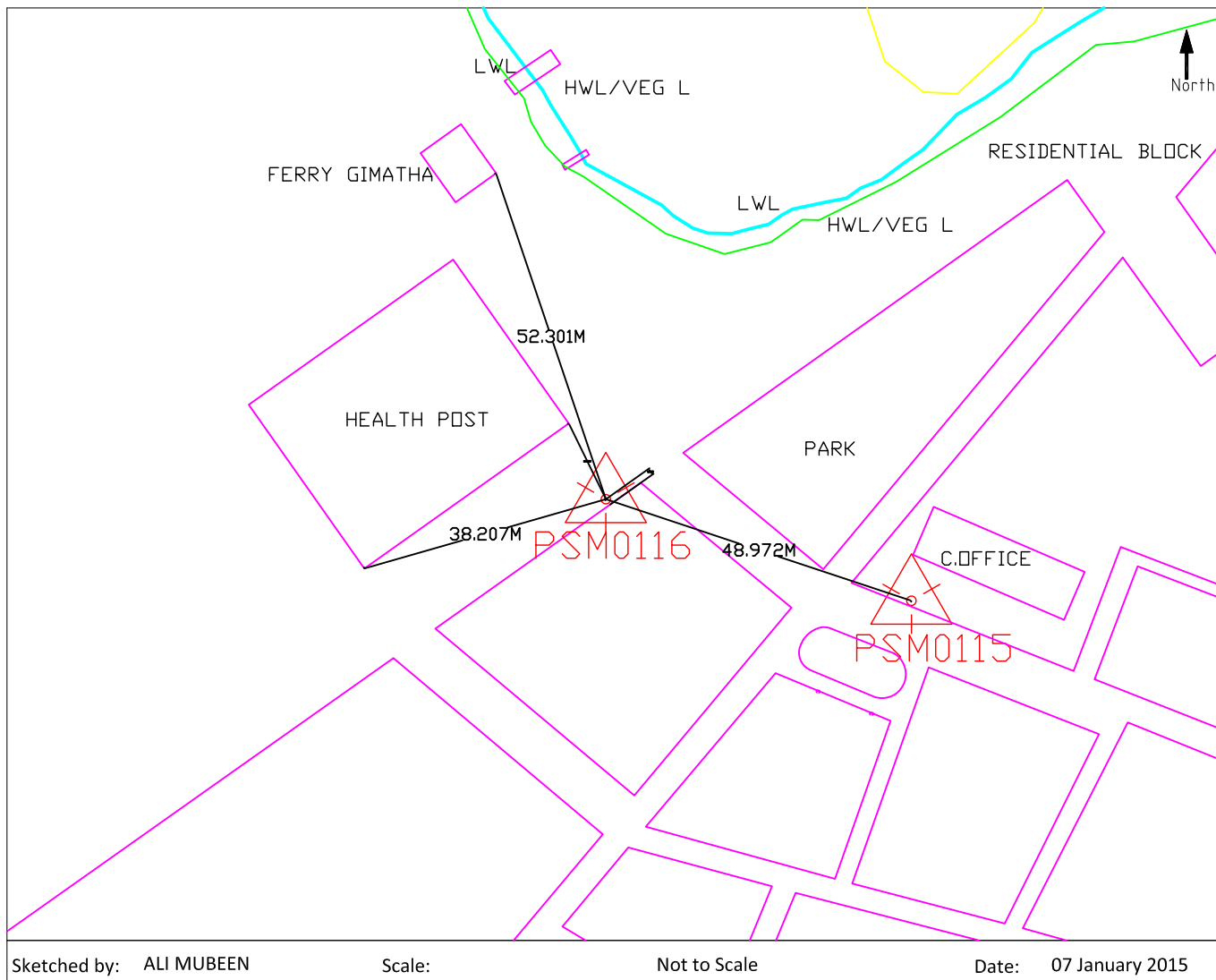
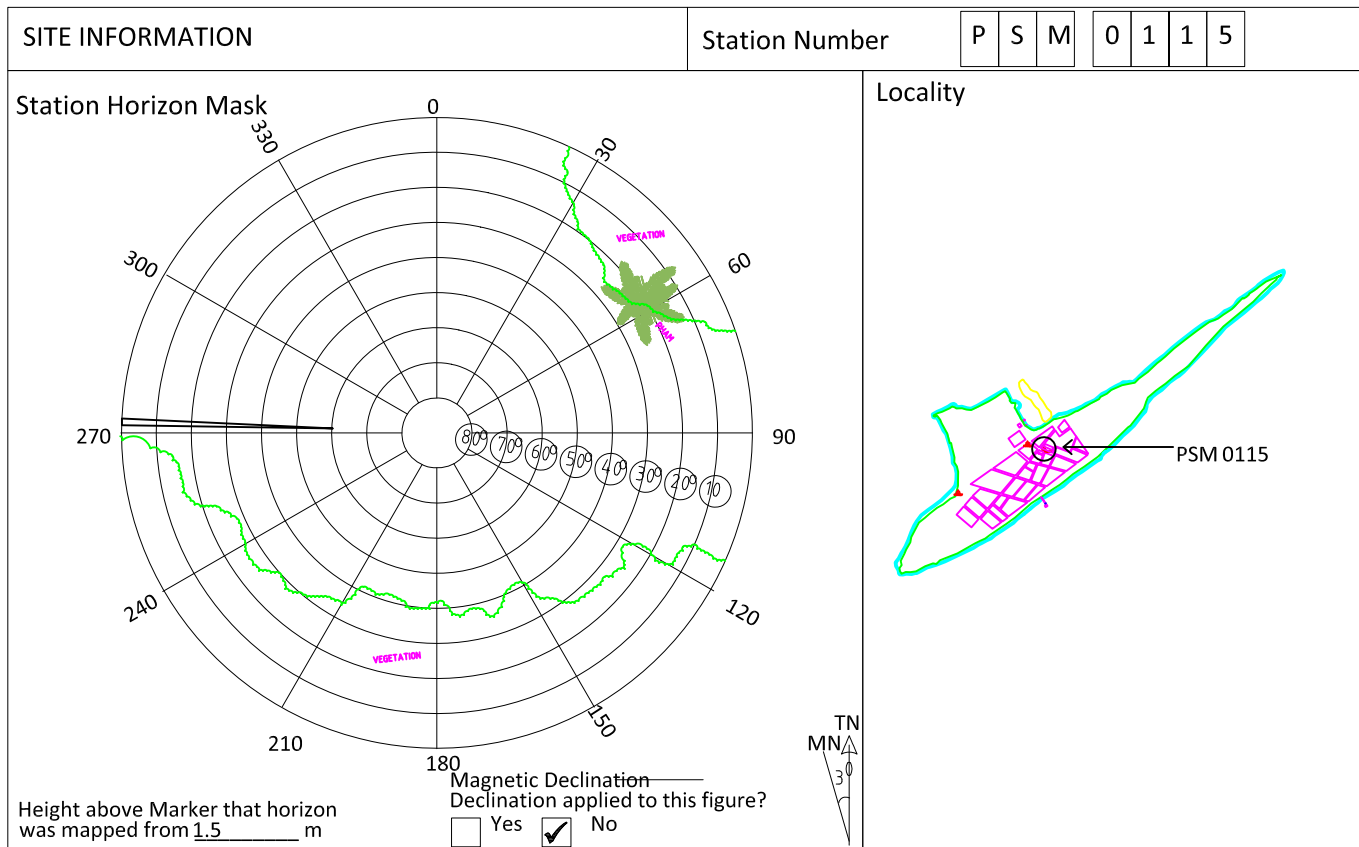

Sketched by: ALI MUBEEN Scale: Not to Scale Date: 07 January 2015

Maldives Land and Survey Authority,
 MINISTRY OF HOUSING AND INFRASTRUCTURE
 Ameenee Magu, Maafannu, Male', 20392, Maldives.
 Office (PABX): +(960) 3004300, Fax: +(960) 3004254
 Email: survey@mhe.gov.mv
 Web: www.surveyofmaldives.gov.mv, www.mhe.gov.mv



CONTROLPOINT DETAILS	Station Number	PSM 0116
Coordinate Information		
Geodetic	Grid	
WGS 84	UTM Zone 43	
Lat: 3° 29' 03.11726" N	E:	264192.6934
Long: 72° 52' 38.80758" E	N:	385379.0041
Ellp Height:	Orth Height:	+1.017
Island Name: Adh.Dhidhdhoo	Date:	07 January 2015

Monument description & method of survey:

- Stainless steel plate fixed to concrete by two bolts
- Horizontal coordinates fixed by GNSS Static survey.
- Elevation reduced relative to Local MSL by double level run
- A concrete block (1x1 ft and 3.2ft in height) with 1.5m stainless steel rod (12mm) was fixed as a PSM

General site condition & access:

- Easily accessible area with wide angle of sky visibility
- Located in the road in front of the health center

Owner: Adh.Dhidhdhoo Island Council



SITE INFORMATION

Station Number

P S M 0 1 1 6

Station Horizon Mask

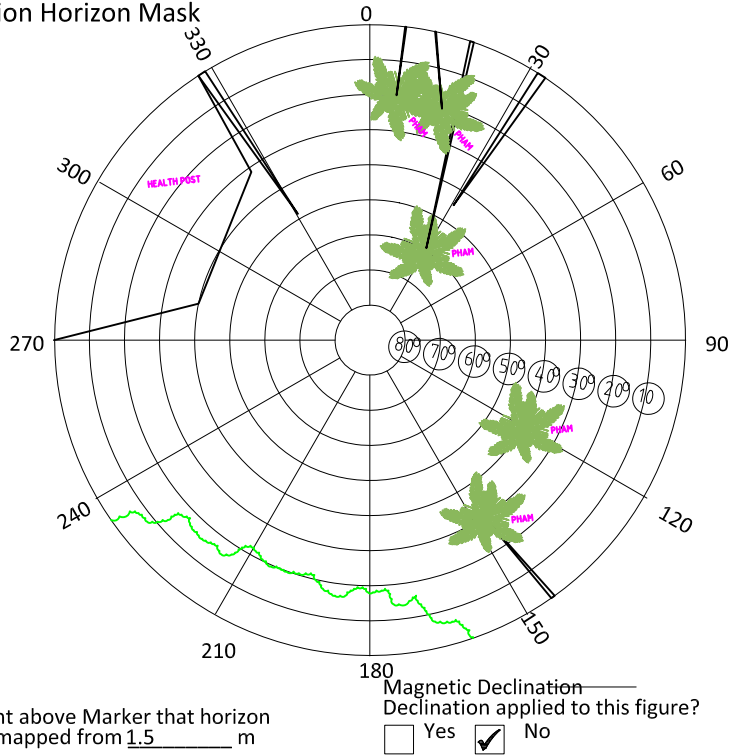

Locality

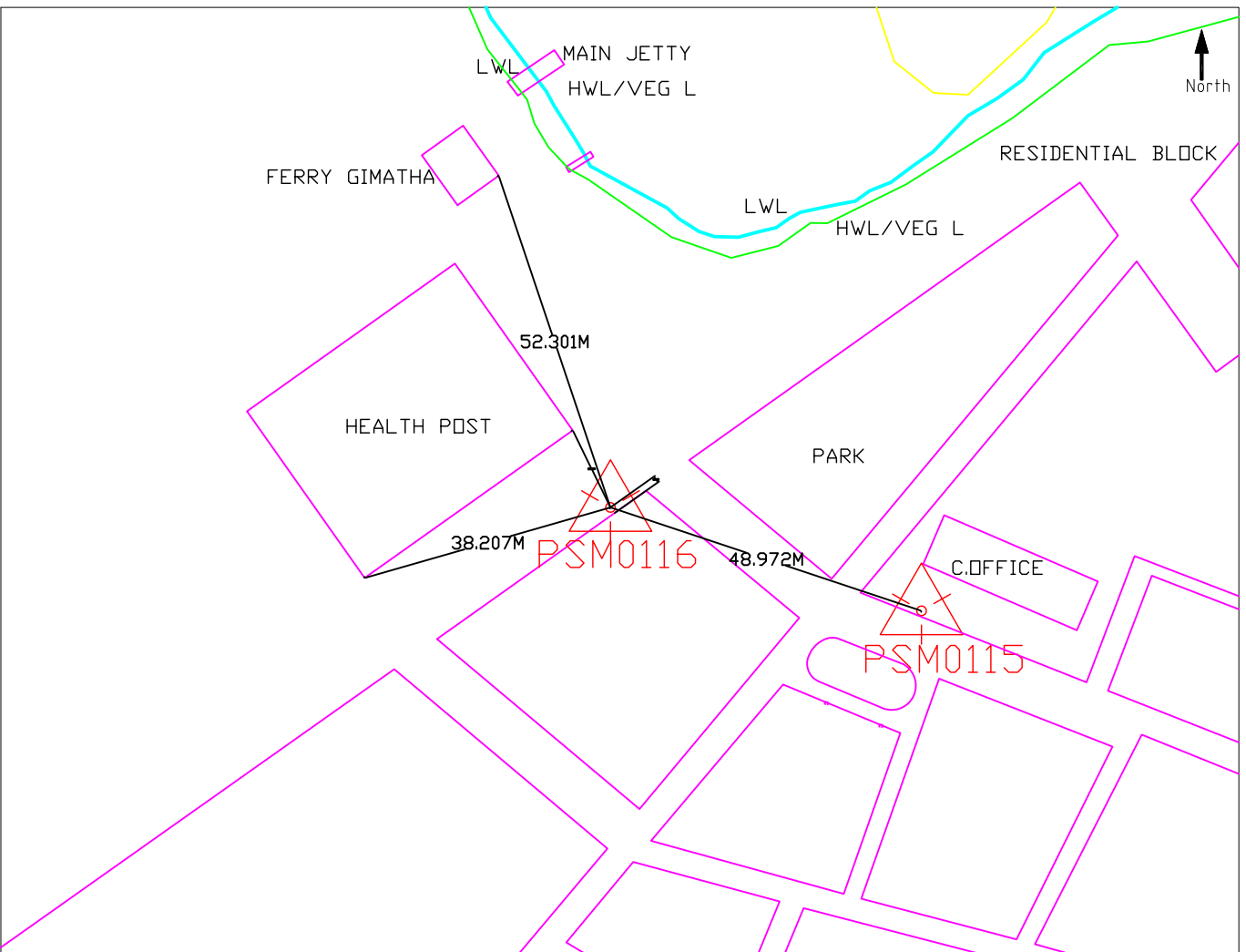
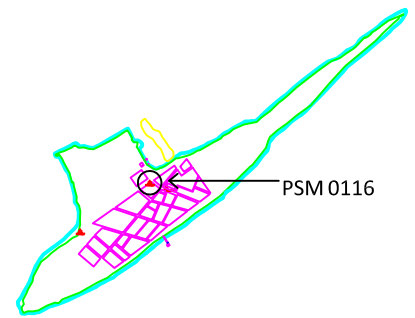

Sketched by: Ali Mubeen

Scale:

Not to Scale

Date: 07 January 2015

Maldives Land and Survey Authority,
 MINISTRY OF HOUSING AND INFRASTRUCTURE
 Ameenee Magu, Maafannu, Male', 20392, Maldives.
 Office (PABX): +(960) 3004300, Fax: +(960) 3004254
 Email: survey@mhe.gov.mv
 Web: www.surveyofmaldives.gov.mv, www.mhe.gov.mv



CONTROLPOINT DETAILS	Station Number PSM 0117
Coordinate Information	
Geodetic	Grid
WGS 84	UTM Zone 43
Lat: 3° 28' 58.59828" N	E: 263995.6388
Long: 72° 52' 32.43520" E	N: 385240.6017
Ellp Height:	Orth Height: +1.283
Island Name: Adh.Dhidhdhoo	Date: 07 January 2015

Monument description & method of survey:

- Stainless steel plate fixed to concrete by two bolts
- Horizontal coordinates fixed by GNSS Static survey.
- Elevation reduced relative to Local MSL by double level run
- A concrete block (1x1 ft and 3.2ft in height) with 1.5m stainless steal rod (12mm) was fixed as a PSM

General site condition & access:

- Easily accessible area with wide angle of sky visibility
- Located in front of the bushes near the school, end the reclaimed land.

Owner: Adh.Dhidhdhoo Island Council



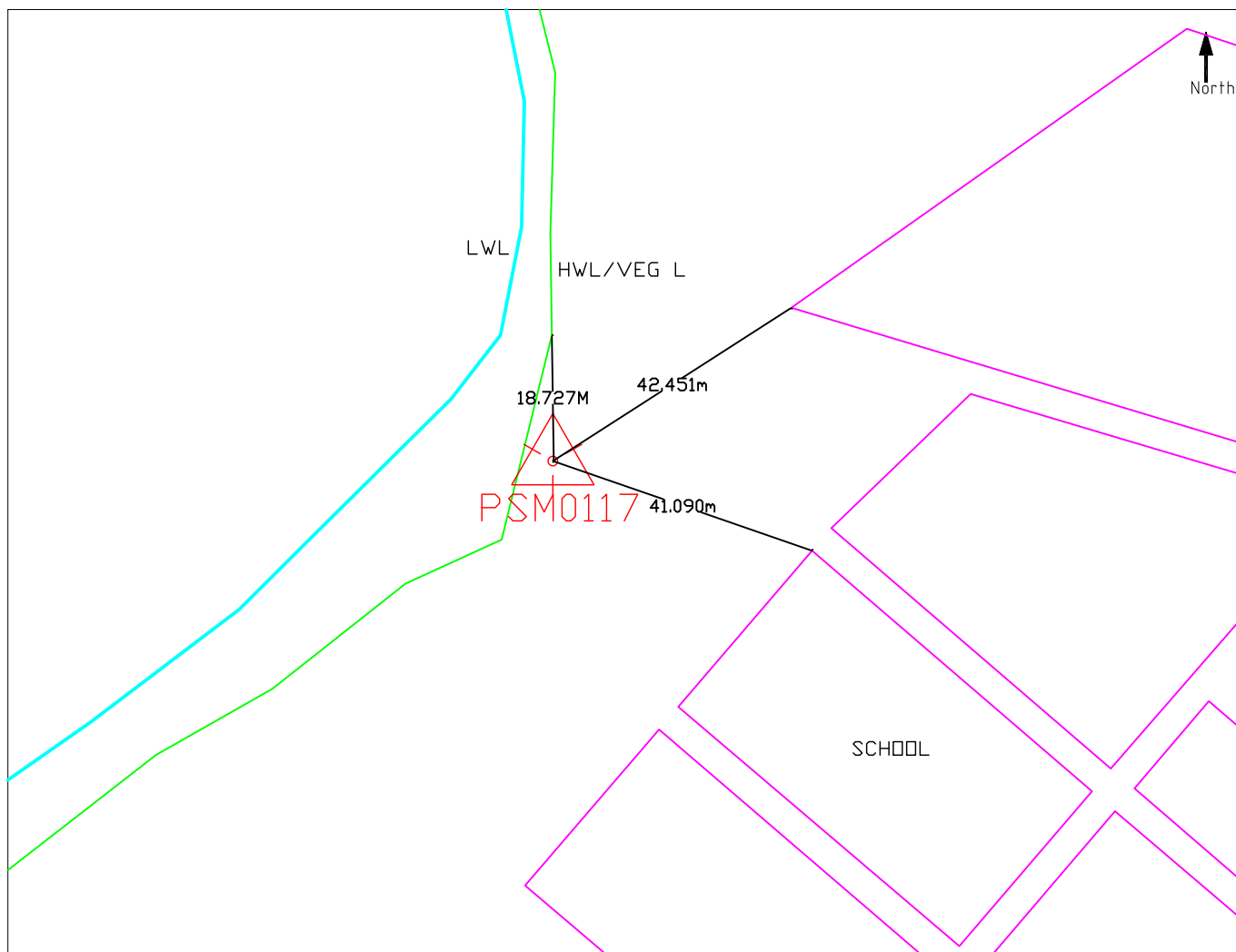
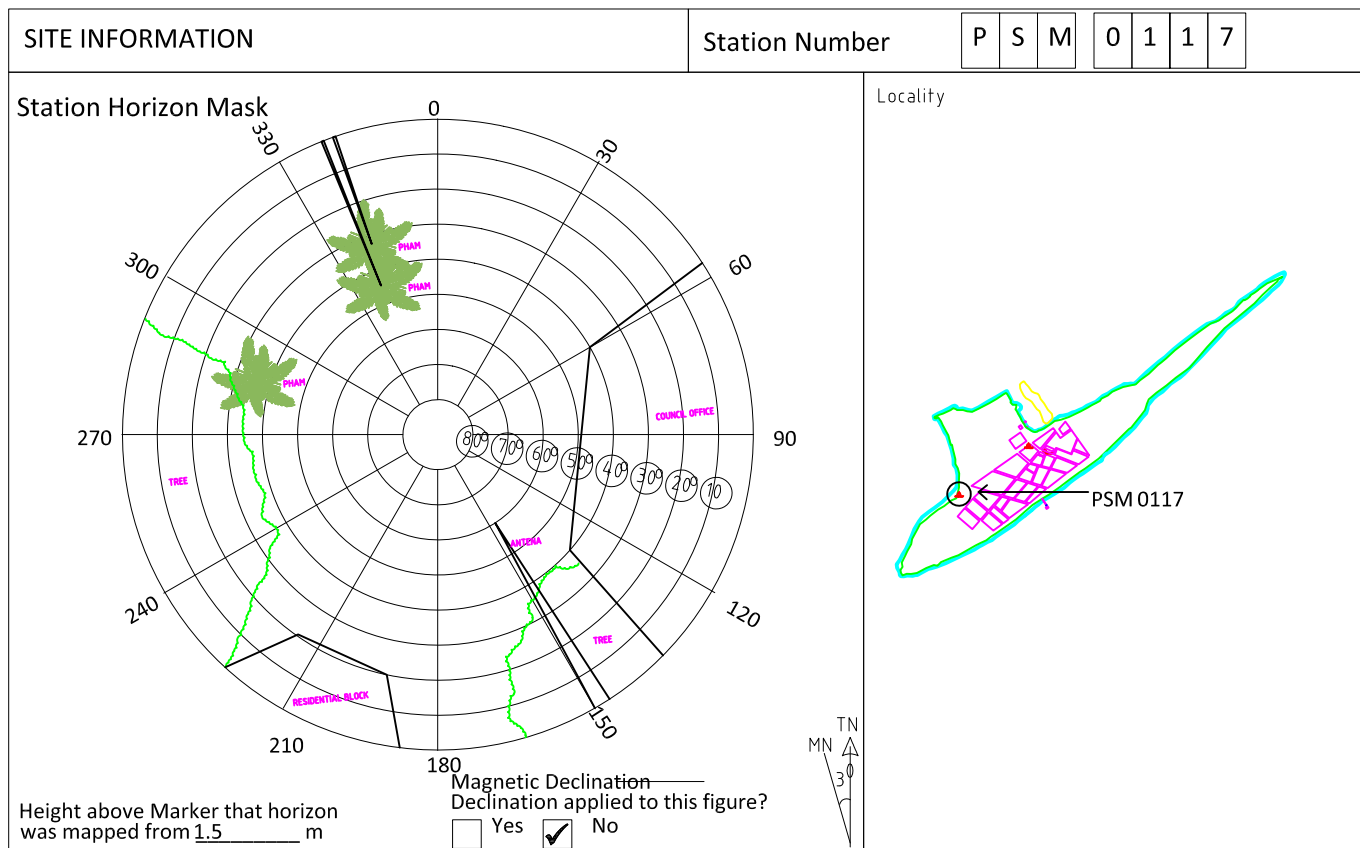

Sketched by: Ali Mubeen Scale: Not to Scale Date: 07 January 2015